

**T.O. 35C1-2-892-1**

---

**TECHNICAL MANUAL**

**OPERATION AND MAINTENANCE INSTRUCTIONS  
WITH ILLUSTRATED PARTS BREAKDOWN  
(ORGANIZATIONAL/INTERMEDIATE)**

**POWER SUPPLY,  
PP-7913/URC, P/N 10087-1000**

Harris Corporation, RF Communications Group  
F04606-82-D-0079

*Distribution Statement - This publication is required for official use or for administrative or operational purposes only. Distribution is limited to US Government agencies. Other requests for this document must be referred to Sacramento ALC/IMMEDTD, McClellan AFB, CA 95652-5609.*

Published under authority of the Secretary of the Air Force

---

**23 JULY 1985**

# LIST OF EFFECTIVE PAGES

INSERT LATEST CHANGED PAGES. DESTROY SUPERSEDED PAGES.

NOTE: The portion of the text affected by the changes is indicated by a vertical line in the outer margins of the page. Changes to illustrations are indicated by miniature pointing hands. Changes to wiring diagrams are indicated by shaded areas.

Dates of issue for original and changed pages are:

Original...0... 23 Jul 85

TOTAL NUMBER OF PAGES IN THIS PUBLICATION IS 52 CONSISTING OF THE FOLLOWING:

| Page No.        | *Change No. |   |
|-----------------|-------------|---|
| Title.....      | 0           | ✓ |
| A.....          | 0           | ✓ |
| i-ix.....       | 0           | ✓ |
| 1-0 - 1-6.....  | 0           | ✓ |
| 2-1 - 2-8.....  | 0           | ✓ |
| 3-1 - 3-2.....  | 0           | ✓ |
| 4-1 - 4-3.....  | 0           | ✓ |
| 4-4 Blank.....  | 0           | ✓ |
| 5-1.....        | 0           | ✓ |
| 5-2 Blank.....  | 0           | ✓ |
| 6-1.....        | 0           | ✓ |
| 6-2 Blank.....  | 0           | ✓ |
| 7-1 - 7-6.....  | 0           | ✓ |
| 8-1.....        | 0           | ✓ |
| 8-2 Blank.....  | 0           | ✓ |
| FP-1.....       | 0           | ✓ |
| FP-2 Blank..... | 0           | ✓ |

\*Zero in this column indicates an original page.

## SAFETY SUMMARY

The following are general safety precautions that are not related to any specific procedures and therefore do not appear elsewhere in this publication. These are recommended precautions that personnel must understand and apply during many phases of operation and maintenance.

### KEEP AWAY FROM LIVE CIRCUITS

Operating personnel must at all times observe all safety regulations. Do not replace components or make adjustments inside the equipment with the high voltage supply turned on. Under certain conditions, dangerous potentials may exist when the power control is in the off position, due to charges retained by capacitors. To avoid casualties, always remove power and discharge circuits to ground before touching any circuit components. Remove watches and rings before performing any maintenance procedures.

### DO NOT SERVICE OR ADJUST ALONE

Under no circumstances should any person reach into or enter the enclosure for the purpose of servicing or adjusting the equipment except in the presence of someone who is capable of rendering aid.

### RESUSCITATION

Personnel working with or near high voltages should be familiar with modern methods of resuscitation. Cardiopulmonary resuscitation procedures are outlined in T.O. 31-1-141-1, and annual refresher

training requirements are outlined in AFOSH STD 127-50.

The following warnings appear in the text in this volume, and are repeated here for emphasis.

#### WARNING

Improper grounding of the 1 KW LPA equipment can cause HIGH VOLTAGE dangerous to life to be present on the equipment chassis in the event of a malfunction.

#### WARNING

Always verify that primary power has been removed at the source before making any TBI terminal board wiring changes.

#### WARNING

This equipment contains voltages that can be dangerous to life.

### HANDLING OF ELECTROSTATIC DISCHARGE SENSITIVE DEVICES (ESDS)

Electrostatic Discharge Sensitive Devices (ESDS) must be handled with certain precautions that must be followed to minimize the effect of static build-up. Consult T.O. 00-25-234, DOD Std-1686, and DOD HDBK 263.

**TABLE OF CONTENTS**

| <b>Section/Para</b>   | <b>Page</b>                       |
|---|-----------------------------------|
| <b>CHAPTER 1. GENERAL INFORMATION</b>                         |                                   |
| 1-1. General Description and Purpose.....                     | 1-1                               |
| 1-2. Equipment Functional Description.....                    | 1-1                               |
| 1-3. Mechanical Design.....                                   | 1-1                               |
| 1-4. Leading Particulators.....                               | 1-1                               |
| 1-5. Capabilities and Limitations.....                        | 1-1                               |
| 1-6. Equipment and Accessories Supplied.....                  | 1-1                               |
| 1-7. Equipment Required but not Supplied.....                 | 1-1                               |
| 1-8. Special Tools and Test Equipment.....                    | 1-1                               |
| 1-9. Related Publications.....                                | 1-3                               |
| <b>CHAPTER 2. INSTALLATION</b>                                |                                   |
| <b>I</b>  | <b>INSTALLATION LOGISTICS</b>     |
| 2-1. Equipment Unpacking Procedure.....                       | 2-1                               |
| 2-2. Preparation for Installation.....                        | 2-1                               |
| 2-3. Site Considerations.....                                 | 2-1                               |
| <b>II</b>   | <b>INSTALLATION PROCEDURE</b>     |
| 2-4. Installing the Equipment.....                            | 2-6                               |
| 2-5. 1KW Power Supply Mounting Instructions.....              | 2-6                               |
| 2-5-1. 1KW Power Supply Stack Mounting Instructions.....      | 2-6                               |
| 2-5-2. 1KW Power Supply Rack Mounting Instructions.....       | 2-6                               |
| 2-6. Cabling Connections.....                                 | 2-6                               |
| 2-7. Checking the Installation.....                           | 2-7                               |
| <b>CHAPTER 3. PREPARATION FOR USE AND RESHIPMENT</b>          |                                   |
| <b>I</b>  | <b>PREPARATION FOR USE</b>        |
| 3-1. Initial Control Settings.....                            | 3-1                               |
| 3-2. Initial Power Application.....                           | 3-1                               |
| 3-3. Step-By-Step Sequence for Initial Power Application..... | 3-1                               |
| 3-4. Initial Checkout.....                                    | 3-1                               |
| <b>II</b>   | <b>PREPARATION FOR RESHIPMENT</b> |
| 3-5. Preparation for Reshipment.....                          | 3-2                               |
| 3-6. Step-By-Step Disassembly Procedure.....                  | 3-2                               |
| 3-7. Step-By-Step Packing and Crating Procedure.....          | 3-2                               |

## TABLE OF CONTENTS (Continued)

| Section/Para                           |   | Page |
|--|---|------|
| CHAPTER 4. OPERATION                   |   |      |
| I                                      | CONTROLS AND INDICATORS                                       |      |
|  | 4-1. Introduction.....  | 4-1  |
|  | 4-2. Indications of Normal Operation.....                     | 4-2  |
| II                                     | OPERATING INSTRUCTIONS  |      |
|  | 4-3. Introduction.....  | 4-3  |
| CHAPTER 5. THEORY OF OPERATION         |   |      |
|  | 5-1. General Description.....                                 | 5-1  |
|  | 5-2. Primary Power Strapping.....                             | 5-1  |
|  | 5.3 Power On Control.....                                     | 5-1  |
|  | 5.4 115 VAC Filament Supply.....                              | 5-1  |
|  | 5.5 13.5 VDC Supply.....                                      | 5-1  |
|  | 5.6 High Voltage Supply.....                                  | 5-1  |
| CHAPTER 6. MAINTENANCE                 |   |      |
|  | 6-1. General.....   | 6-1  |
|  | 6-2. Periodic Maintenance.....                                | 6-1  |
| CHAPTER 7. ILLUSTRATED PARTS BREAKDOWN |   |      |
| I                                      | INTRODUCTION  |      |
|  | 7-1. Purpose.....   | 7-1  |
|  | 7-2. Scope.....   | 7-1  |
|  | 7-3. Chapter Organization.....                                | 7-1  |
|  | 7-4. Source, Maintenance, and Recoverability (SMR) Codes..... | 7-1  |
|  | 7-5. Federal Supply Codes for Manufacturers (FSCM).....       | 7-1  |
| II                                     | MAINTENANCE PARTS LIST  |      |

LIST OF ILLUSTRATIONS

| Figure                                 |  | Page |
|--|--|------|
| CHAPTER 1. GENERAL INFORMATION         |  |      |
| 1-1                                    | Power Supply PP-7913/URC .....                     | 1-0  |
| 1-2                                    | Mechanical Construction ..                         | 1-2  |
| CHAPTER 2. INSTALLATION                |  |      |
| 2-1                                    | Unpacking the Equipment .....                      | 2-2  |
| 2-2                                    | Rear Panel Detail and Strapping Instructions ..... | 2-2  |
| 2-3                                    | Typical Stack Mount Detail .....                   | 2-5  |
| 2-4                                    | Dimensions .....                                   | 2-7  |
| CHAPTER 4. OPERATION                   |  |      |
| 4-1                                    | Operating Controls and Indicators .....            | 4-2  |
| CHAPTER 7. ILLUSTRATED PARTS BREAKDOWN |  |      |
| 7-1                                    | 1 KW Power Supply, PP-7913/URC .....               | 7-1  |
| CHAPTER 8. FOLDOUT DRAWINGS            |  |      |
| FO-1                                   | 1 KW Power Supply Schematic Diagram                |      |

## LIST OF TABLES

| Table                          |   | Page |
|--------------------------------|---|------|
| CHAPTER 1. GENERAL INFORMATION |   |      |
| 1-1                            | Leading Particulars .....                 | 1-4  |
| 1-2                            | Capabilities and Limitations .....        | 1-5  |
| 1-3                            | Equipment and Accessories Supplied .....  | 1-5  |
| 1-4                            | Equipment Required but Not Supplied ..... | 1-5  |
| 1-5                            | Related Publications .....                | 1-6  |
| CHAPTER 2. INSTALLATION        |   |      |
| 2-1                            | Interconnection Cabling Information ..... | 2-8  |

**GLOSSARY**

|         |   |
|---------|---|
| A       | Ampere(s)   |
| A/D     | Analog-to-Digital (Converter)   |
| AFSK    | Audio frequency shift keying; a baseband modulation scheme in which two audio frequencies are used to represent binary coded data; the frequency is shifted to one frequency to represent a 1 (mark) and to the other to represent a 0 (space). |
| AGC     | Automatic gain control  |
| ALE     | Address latch enable  |
| AM      | Amplitude modulation; a modulation scheme in which the carrier is made to vary in amplitude in accordance with the modulating signal.   |
| AME     | Amplitude modulation equivalent   |
| ANTIVOX | Prevents false VOX operation; see VOX   |
| BFO     | Beat Frequency Oscillator, used in SSB detection circuits   |
| BIT     | Built-in Test   |
| BIU     | Bus interface unit  |
| BW      | Bandwidth   |
| CPU     | Central processing unit   |
| CREV    | Converter reverse   |
| CW      | Continuous wave; a wave that does not vary in amplitude or frequency and is turned on and off to carry intelligence, e.g., Morse Code   |
| D/A     | Digital-to-Analog (Converter)   |
| dB      | Decibel(s)  |
| dBm     | Decibel(s) relative to one milliwatt  |
| EMI     | Electromagnetic interference  |
| EPROM   | Erasable programmable read-only memory  |
| EU      | Execution unit  |
| HF      | High frequency; a radio frequency band extending from about 3 MHz to 30 MHz; in this manual, HF includes 1.6 to 30 MHz.   |
| HV      | High voltage  |
| IF      | Intermediate frequency  |
| IM      | Intermodulation (distortion)  |
| I/O     | Input/Output  |
| KREV    | Keyer reverse   |
| LCD     | Liquid crystal display  |
| LED     | Light emitting diode  |
| LPA     | Linear power amplifier  |
| LSB     | Lower sideband; a modulation scheme in which the intelligence is carried on the first sideband below the carrier frequency; see SSB   |
| MIC     | Microphone  |
| mA      | Milliampere(s)  |
| mV      | Millivolt(s)  |
| NBSV    | Narrow band secure voice  |
| PEP     | Peak envelope power   |
| PPC     | Peak power control  |
| PWB     | Printed wiring board  |
| RAM     | Random access memory  |
| rms     | Root mean square  |
| RTC     | Real time clock   |
| RX      | Receive   |

## GLOSSARY (Continued)

|        |   |
|--------|---|
| S TONE | Sidetone  |
| SSB    | Single sideband; a modulation scheme in which the intelligence is carried by one of the carrier sidebands, the other sideband and the carrier center frequency being suppressed |
| TGC    | Transmitter gain control  |
| TX     | Transmit  |
| uA     | Microampere(s)  |
| uP     | Microprocessor  |
| USB    | Upper sideband; a modulation scheme in which the intelligence is carried on the first sideband above the carrier frequency; see SSB   |
| uV     | Microvolt(s)  |
| Vac    | Volts, alternating current  |
| VCO    | Voltage controlled oscillator   |
| Vdc    | Volts, direct current   |
| VOX    | Voice operated transmission   |
| VSWR   | Voltage standing wave ratio; the ratio of the maximum to the minimum voltage of a standing wave on a radio frequency transmission line  |
| W      | Watt(s)   |

## **INTRODUCTION**

The purpose of this on-equipment level manual is to provide all information necessary for the installation, operation and on-equipment maintenance of Power Supply, PP-7913/URC, manufactured by the RF Communications Group of Harris Corporation, Rochester, New York. The manual is divided into eight chapters. The contents of each chapter are briefly described in the following paragraphs.

Chapter 1 provides a general description and a list of capabilities and limitations of the Power Supply, PP-7913/URC. A list of companion equipment references are included along with the components that form the PP-7913/URC.

Chapter 2 provides the information necessary for planning and carrying out the installation of the Power Supply, PP-7913/URC. A dimensional outline drawing is provided to show dimensions and other information required for proper installation.

Chapter 3 provides instructions for preparing the Power Supply, PP-7913/URC for use, including the initial application of power and checkout. Instructions for repacking the equipment for reshipment are also included in Chapter 3.

Chapter 4 provides complete operating instructions for the Power Supply, PP-7913/URC in all modes and contains a list of operating controls and indicators.

Chapter 5 provides a complete theory of operation for the Power Supply, PP-7913/URC. An overall theory and detailed theory of individual functional circuits are provided.

Chapter 6 describes the on-equipment location maintenance procedures. On-equipment location maintenance is based on the use of built-in test (BIT) features of the equipment to isolate problems to the replaceable subassembly or printed wiring board (PWB) level. Depot maintenance is supplied in a separate publication, T.O. 35C1-2-892-3. The Depot Manual is based on performance testing and trouble analysis of the subassembly or PWB to locate and replace faulty parts at the lowest replaceable unit level (LRU).

Chapter 7 contains the Illustrated Parts Breakdown (IPB) information at the on-equipment level. This includes assemblies and parts that may be replaced at the on-equipment location.

Chapter 8 contains all fold-out (FO) drawings. A cross reference list is provided as well as the individual drawings referenced throughout chapters 1 to 7. The diagrams are numbered FO-1, FO-2, etc. They are printed on sheets with page-size blank aprons to permit viewing the diagram with the rest of the book closed or opened to another page.

**APPLICABLE SPECIFICATIONS**

The following specifications, standards, and publications were used in the preparation of this manual.

| <b>SPECIFICATION</b>            | <b>NAME</b>   |
|---------------------------------|---|
| MIL-M-38798B, para. 3.4         | Combined Operation and Maintenance Instructions Manual (Equipment). |
| MIL-M-38807, Amend. 4           | Preparation of Illustrated Parts Breakdown.                         |
| MIL-M-38790 and<br>MIL-M-38784A | General Requirements for Preparation of Technical Manuals.          |

**APPLICABLE STANDARDS**

| <b>STANDARD</b> | <b>NAME</b>   |
|-----------------|---|
| MIL-STD-12      | Abbreviations for use on Drawings and in Technical Type Publications. |
| MIL-STD-15-1A   | Graphic Symbols for Electrical Components.                            |
| MIL-STD-17-1    | Mechanical Symbols.   |
| MIL-STD-806     | Graphic Symbols for Logic Diagrams.                                   |

**APPLICABLE PUBLICATIONS**

| <b>PUBLICATION</b>     | <b>NAME</b>   |
|------------------------|---|
| DOD 5200.20            | Distribution Statements on Technical Documents.                     |
| USAS Y14.15-1966       | Electrical and Electronic Diagrams.                                 |
| USAS Y32.16-1968       | Electrical and Electronic Reference Designations.                   |
| T.O. 31-1-141 (Series) | Technical Manual-Basic Electronic Technology and Testing Practices. |

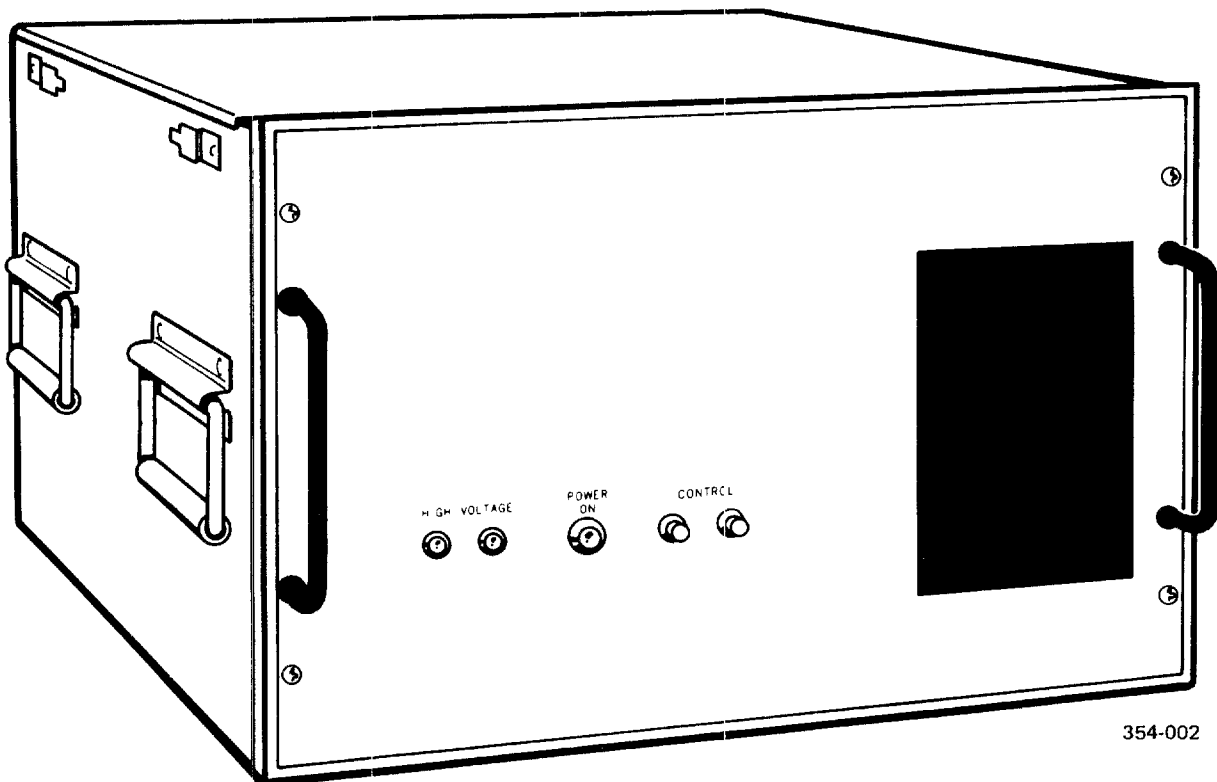

Figure 1-1. Power Supply PP-7913/URC

## CHAPTER 1

## GENERAL INFORMATION

**1-1. GENERAL DESCRIPTION AND PURPOSE.** Power Supply PP-7913/URC, shown in figure 1-1, and hereafter known as the 1KW Power Supply, is a 115/208/230 Vac, 10%, single-phase 50/60/400 Hz power supply that produces three output voltages: +3000 Vdc at 1A, +13.5 Vdc at 8A, and 115 Vac at 1A.

a. Applications. The 1KW Power Supply is rated for continuous duty applications where the load requirement is to satisfy the demands of a 1KW Linear Power Amplifier rated for 1KW peak and average output power.

b. Reliability. The 1KW Power Supply is designed for continuous operation under the most severe environmental conditions. It is intended for fixed station applications.

c. Test Features. The 1KW Power Supply provides analog outputs for use in metering and built-in-test (BIT) evaluation.

d. Power Requirements. Primary power requirements are for 115 Vac @ 40 amperes maximum, or 208/230 Vac @ 20/18 amperes maximum. The primary power frequency can be 50, 60, or 400 Hz. The primary power source should be capable of delivering 4000 volt-amperes..

## 1-2. EQUIPMENT FUNCTIONAL DESCRIPTION.

a. +13.5 VDC Section. The +13.5 Vdc power supply section uses a full-wave rectifier at the output of a LV power transformer to produce this general purpose output. The primary of the transformer can be strapped for proper primary voltage at a terminal board accessible at the rear panel. Both sides of the transformer primary are protected by circuit breakers. Primary voltage to the LV Power Supply is controlled by the application of +13.5 Vdc from an external source, through two interlocks on the Power Supply, to the LV power-on relay.

b. HV Supply Section. The HV power supply section uses a full-wave bridge rectifier to produce a single +3000 Vdc output. The primary of the HV transformer can be strapped for either 115 Vac, 208 Vac, or 230 Vac. The transformer and the HV output circuit are protected by circuit breakers in each side of the line. The HV supply is controlled by the HV ON control line which furnishes a control ground to the HV contactor.

c. 115 Vac Section. 115 Vac is made available directly from the strapped primary side of the LV power transformer as tube filament power for the 1 KW LPA.

**1-3. MECHANICAL DESIGN.** The mechanical construction of the 1KW Power Supply is shown in figure 1-2.

**1-4. LEADING PARTICULARS.** The characteristics of the 1KW Power Supply are summarized in table 1-1. This table includes physical data and operating/storage environment data.

**1-5. CAPABILITIES AND LIMITATIONS.** The capabilities and limitations of the 1KW Power Supply are described in table 1-2. For interconnection information, see table 2-1.

**1-6. EQUIPMENT AND ACCESSORIES SUPPLIED.** Table 1-3 lists the assemblies, components, units, cables, and accessory kits supplied with the 1 KW Power Supply.

**1-7. EQUIPMENT REQUIRED BUT NOT SUPPLIED.** Table 1-4 lists equipment required, but not supplied, for the installation and operation of the 1 KW Power Supply. It is specifically designed to interface with the equipment listed in table 1-4.

**1-8. SPECIAL TOOLS AND TEST EQUIPMENT.** The servicing and maintenance of the 1 KW Power Supply do not require any special tools, test jigs, or fixtures. There are no adjustments in the 1 KW Power Supply. Field maintenance for the 1KW Power Supply is limited to replacing the

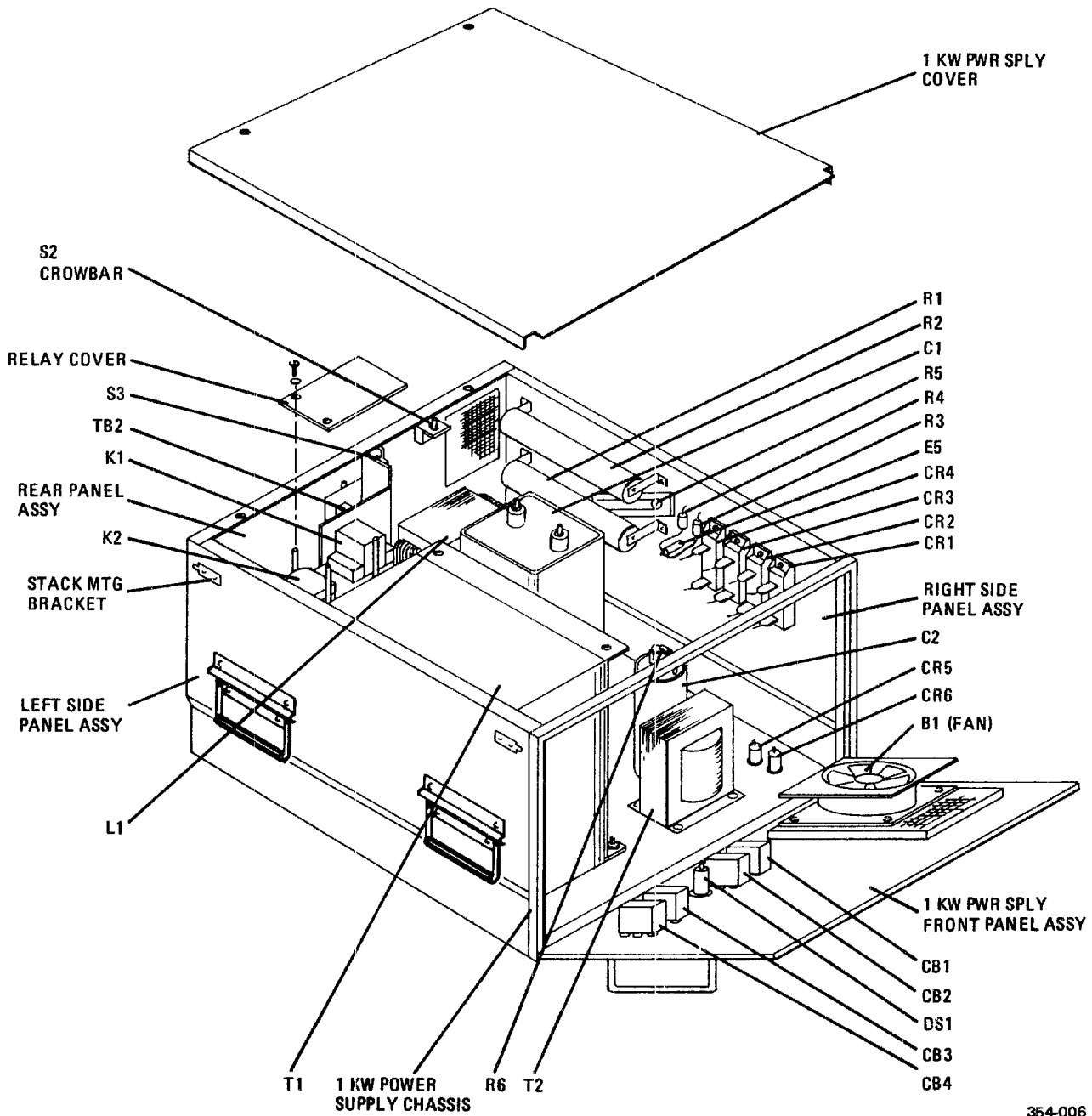

354-006

Figure 1-2. Mechanical Construction

components identified in Chapter 7, Illustrated Parts Breakdown. Refer to the Depot Manual for a list of test equipment used to service this equipment at the Depot level

**1-9. RELATED PUBLICATIONS.** Table 1-5 lists the Technical Order publications related to use of the 1 KW Power Supply.

**Table 1-1. Leading Particulars**

| Item  | Characteristic or Value  |
|---|--|
| Dimensions:<br>Height:<br>Width:<br>Depth:<br>Weight: | 10.5 inches (26.6 cm)<br>16.8 inches (42.5 cm)<br>18.8 inches (47.7 cm)<br>135 pounds (9.1 kg) |
| Power Requirements                                    | 115/208/230 Vac @ 4/20/8 Amps (maximum)  |
| Operating Environment                                 | -30 to +50 degrees C   |
| Storage Environment                                   | -60 to +60 degrees C<br>99% Humidity   |
| Operating Altitude                                    | 10,000 feet  |
| Transport Altitude                                    | 40,000 Feet  |
| Shock/Vibration                                       | MIL-STD-810C   |
| Cooling   | Convection and forced air (built-in fan)   |
| Cabling Requirements                                  | Power and control  |
| Transportability                                      | Manual Methods Apply   |
| Set-up Time   | Less than 1 hour   |

**Table 1-2. Capabilities and Limitations**

| Description of Characteristic |  |         |           |          |     |           |         |           |         |             |     |            |           |            |             |            |           |
|-------------------------------|--|---------|-----------|----------|-----|-----------|---------|-----------|---------|-------------|-----|------------|-----------|------------|-------------|------------|-----------|
| Primary Power                 | 115, 208, or 230 Vac, 10%, single phase, 50-400 Hz   |         |           |          |     |           |         |           |         |             |     |            |           |            |             |            |           |
| Remote Capability             | 6 feet (1.83 M) separation (typical) between 1 KW Power Supply and 1 KW LPA  |         |           |          |     |           |         |           |         |             |     |            |           |            |             |            |           |
| Control Lines: (J1)           | <table> <tr> <td>PWR ON:</td> <td>+13.5 Vdc</td> </tr> <tr> <td>H.V. ON:</td> <td>GND</td> </tr> <tr> <td>Filament:</td> <td>115 Vac</td> </tr> <tr> <td>Filament:</td> <td>115 Vac</td> </tr> <tr> <td>PWR ON Ret:</td> <td>GND</td> </tr> <tr> <td>+13.5 Vdc:</td> <td>+13.5 Vdc</td> </tr> <tr> <td>B+ Sample:</td> <td>0 - +30 Vdc</td> </tr> <tr> <td>+3000 Vdc:</td> <td>+3000 Vdc</td> </tr> </table> | PWR ON: | +13.5 Vdc | H.V. ON: | GND | Filament: | 115 Vac | Filament: | 115 Vac | PWR ON Ret: | GND | +13.5 Vdc: | +13.5 Vdc | B+ Sample: | 0 - +30 Vdc | +3000 Vdc: | +3000 Vdc |
| PWR ON:                       | +13.5 Vdc  |         |           |          |     |           |         |           |         |             |     |            |           |            |             |            |           |
| H.V. ON:                      | GND  |         |           |          |     |           |         |           |         |             |     |            |           |            |             |            |           |
| Filament:                     | 115 Vac  |         |           |          |     |           |         |           |         |             |     |            |           |            |             |            |           |
| Filament:                     | 115 Vac  |         |           |          |     |           |         |           |         |             |     |            |           |            |             |            |           |
| PWR ON Ret:                   | GND  |         |           |          |     |           |         |           |         |             |     |            |           |            |             |            |           |
| +13.5 Vdc:                    | +13.5 Vdc  |         |           |          |     |           |         |           |         |             |     |            |           |            |             |            |           |
| B+ Sample:                    | 0 - +30 Vdc  |         |           |          |     |           |         |           |         |             |     |            |           |            |             |            |           |
| +3000 Vdc:                    | +3000 Vdc  |         |           |          |     |           |         |           |         |             |     |            |           |            |             |            |           |

**Table 1-3. Equipment and Accessories Supplied**

| Qty | Item                        | Use   |
|-----|-----------------------------|---|
| 1   | Power Supply<br>PP-7913/URC | Provides the operating voltages to the 1 KW LPA |

**Table 1-4. Equipment Required but Not Supplied**

| Qty              | Item                                | Description   |
|------------------|-------------------------------------|---|
| 1                | 100 Watt Transceiver<br>RT-1446/URC | Companion equipment used for reception and transmission of RF signals.        |
| 1                | 1 KW LPA<br>AM-7224/URC             | Companion equipment that amplifies 100 Watt Transceiver output to 1 KW level. |
| 1                | Coupler, Antenna<br>AN/URA-38( )    | Companion equipment used to match the 1 KW LPA to the antenna system.         |
| 1 drop per screw | Loctite #242 (Blue)                 | Used to hold handles to front panel.  |

Table 1-5. Related Publications

| Title  | Publication No.  |
|--|--|
| 100/500 Watt Antenna Coupler, CU-2310/URC<br>On-Equipment Manual<br>Depot Manual<br>Work Cards | T.O. 31R2-2URC-111<br>T.O. 31R2-2URC-113<br>T.O. 31R2-2URC-116WC-1 |
| Receiver-Transmitter, Radio, RT-1446/URC<br>On-Equipment Manual<br>Depot Manual<br>Work Cards  | T.O. 31R2-2URC-81<br>T.O. 31R2-2URC-83<br>T.O. 31R2-2URC-86WC-1    |
| Amplifier, Radio Frequency, AM-7223/URC<br>On-Equipment Manual<br>Depot Manual<br>Work Cards   | T.O. 31R2-2URC-101<br>T.O. 31R2-2URC-103<br>T.O. 31R2-2URC-106WC-1 |
| Power Supply, PP-7913/URC<br>On-Equipment Manual<br>Depot Manual<br>Work Cards                 | T.O. 35C1-2-892-1<br>T.O. 35C1-2-892-3<br>T.O. 35C1-2-892-6WC-1    |
| Amplifier, Radio Frequency, AM-7224/URC<br>On-Equipment Manual<br>Depot Manual<br>Work Cards   | T.O. 31R2-2URC-121<br>T.O. 31R2-2URC-123<br>T.O. 35C1-2-892-6WC-1  |
| Remote Control Unit, C-11329/URC<br>On-Equipment Manual<br>Depot Manual<br>Work Cards          | T.O. 31R2-2URC-91<br>T.O. 31R2-2URC-93<br>T.O. 31R2-2URC-96WC-1    |
| Overall System<br>Work Cards   | T.O. 31R2-2URC-126WC-1   |

## CHAPTER 2

### INSTALLATION

---

#### WARNING

Dangerous voltages exist in this radio equipment. Before removing any covers, disconnect primary power.

#### Section I. INSTALLATION LOGISTICS

**2-1. EQUIPMENT UNPACKING PROCEDURE.** The 1KW Power Supply is packed in a corrugated cardboard box for shipment. A two-piece foam enclosure protects the equipment from rough handling.

- a. When the unit is received, carefully inspect the exterior of the box. Look for any damage, signs of rough handling or weather exposure (e.g., water damage) or signs that the box may have been tampered with. If any of these conditions are present, carefully note and report them to the proper authority (refer to T.O. 00-35D-54). An external sticker on the shipping box provides additional instructions concerning inspection of the package.
- b. Refer to figure 2-1 for instructions concerning unpacking the box. The box consists of double-walled cardboard with reinforced strapping tape. The tool required to open the box is a sharp knife. Use the knife carefully to avoid injury when opening the box. Keep the packing box in a secure place for possible future use.
- c. After removing the equipment from the box, use the packing list in the ancillary package to verify the presence of each item in the shipment. Any shortages of items should be reported to the proper authority (refer to T.O. 00-35D-54).
- d. The boxed equipment weighs a total of 145 pounds (65.7 Kg). Use normal care to move the boxed equipment into the general location where it is to be installed. Once unpacked, the 1KW Power Supply weighs a total of 135 pounds and may be handled by two individuals.

**2-2. PREPARATION FOR INSTALLATION.** Site selection is the most important consideration in preparing for installation of the equipment. Details for site selection will vary depending on the use of the 1KW Power Supply.

**2-3. SITE CONSIDERATIONS.** A number of factors should be considered, from security to operational requirements, and it is the responsibility of the user to determine which has precedence. Each of the following items should be considered in site selection:

- a. Power Source. Power requirements are identified in table 1-1 (see chapter 1 of this manual). Figure 2-2 shows rear panel detail and gives power supply strapping instructions. Consideration must be given to the type and size of power cable used to allow for the voltage and current that is required (table 1-1).
- b. Loading. Depending on the installation method, be sure the selected space has adequate strength to support the weight of the equipment.
- c. Accessibility. Consider the space needed for access to the equipment for servicing, operating, maintenance, etc.
- d. 1KW LPA. Location of the 1KW Power Supply should take into account the location of the 1KW LPA. Avoid long cable runs (6 feet is typical).
- e. System Ground. Make sure the system is properly grounded for safety (e.g., lightning hazard) (refer to T.O. 31-10-24).

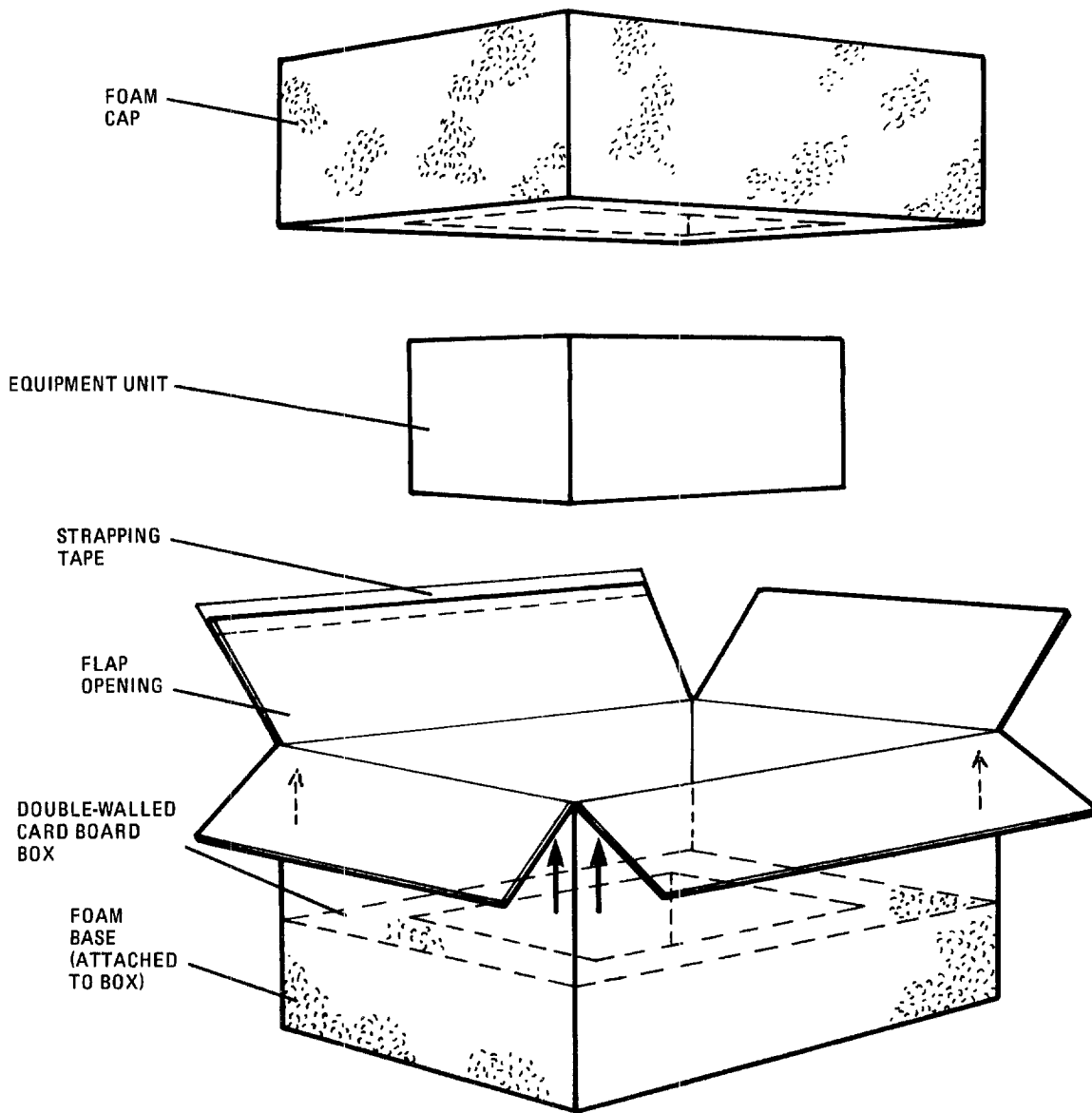

UNPACKING PROCEDURE

1. PLACE BOX ON FLOOR WITH ARROWS MARKED ON EACH SIDE POINTING UP.
2. CUT TAPE ON TOP OF BOX AND REMOVE FOAM CAP FROM BOX.
3. LIFT EQUIPMENT UNIT OUT OF BOX.
4. SAVE BOX AND FOAM CAP FOR RESHIPMENT.

350-003

Figure 2-1. Unpacking the Equipment

**TB2 Primary Power Jumpering**

| Nominal Voltage | Jumper 1 | Jumper 2 | Jumper 3 | Jumper 4 | #14 AWG Jumper |
|-----------------|----------|----------|----------|----------|----------------|
| 115 Vac         | 2 to 6   | 4 to 8   | 10 to 12 | 9 to 11  | Connect to 2   |
| 208 Vac         | 4 to 7   | (None)   | 10 to 13 | (None)   | Connect to 3   |
| 230 Vac         | 4 to 6   | (None)   | 10 to 11 | (None)   | Connect to 2   |

**NOTES**

1. Numbers above refer to terminals on TB2.
2. Jumpers must be of #14 AWG wire minimum.
3. Do not complete jumper connections with primary power applied to TB1.

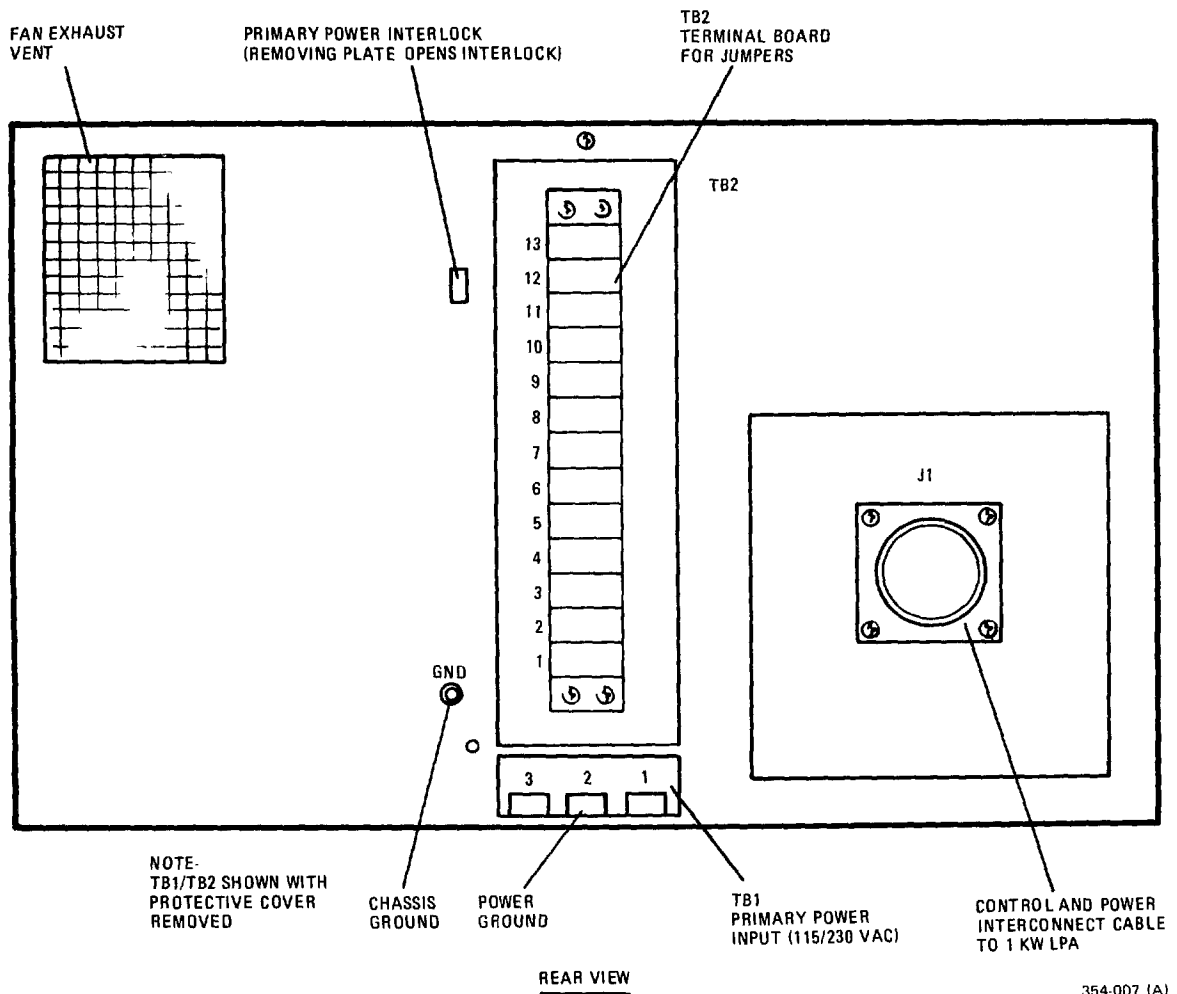

**Figure 2-2. Rear Panel Detail and Strapping Instructions**

f. Environment. The 1KW Power Supply will operate normally over an ambient temperature range of -30 to + 50 degrees C.

g. Interaction. The 1KW Power Supply should not interfere with or have interference problems with adjacent electronic equipment.

h. Heat Dissipation. Heat dissipation is not normally a problem with the 1KW Power Supply. Avoid positioning near other heat sources, and provide adequate ventilation.

i. Servicing. Allow for space to store any replacement assemblies, servicing tools, and test equipment.

j. Companion Equipment. Since the 1KW Power Supply is to be operated in conjunction with some of the companion equipment identified in table 1-4 (see chapter 1 of this manual), additional considerations may be required as identified in the companion equipment manuals.

k. Mounting. Once the site has been selected, the method of mounting the equipment should be considered. Each mounting method requires a particular type of mounting hardware. The mounting holes at the sides of the equipment can be used for slide mounts, brackets, posts, etc., depending on the manner of installation. Most installations of the equipment will result in one of the mounting techniques described in the following paragraphs.

l. Installation Configuration. The 1KW Power Supply interfaces with the 1KW LPA via the PA-PS control cable.

m. Grounding. Proper grounding of the 1KW Power Supply is recommended to prevent possible serious personnel hazards in the event of equipment malfunctions (refer to T.O. 31-10-24). Should be 10 ohms or less.



Improper grounding of the 1KW LPA equipment can cause HIGH VOLTAGE which is dangerous to life to be present on the equipment chassis in the event of a malfunction.

The ground straps should be constructed of wide copper material or braid, and should be as short as possible. Ground straps should be clamped and bonded to a cold water pipe or other metal conductor that provides a good ground.

n. Typical 1KW LPA Installation. A typical stack mount 1KW Power Supply installation is shown in figure 2-3.

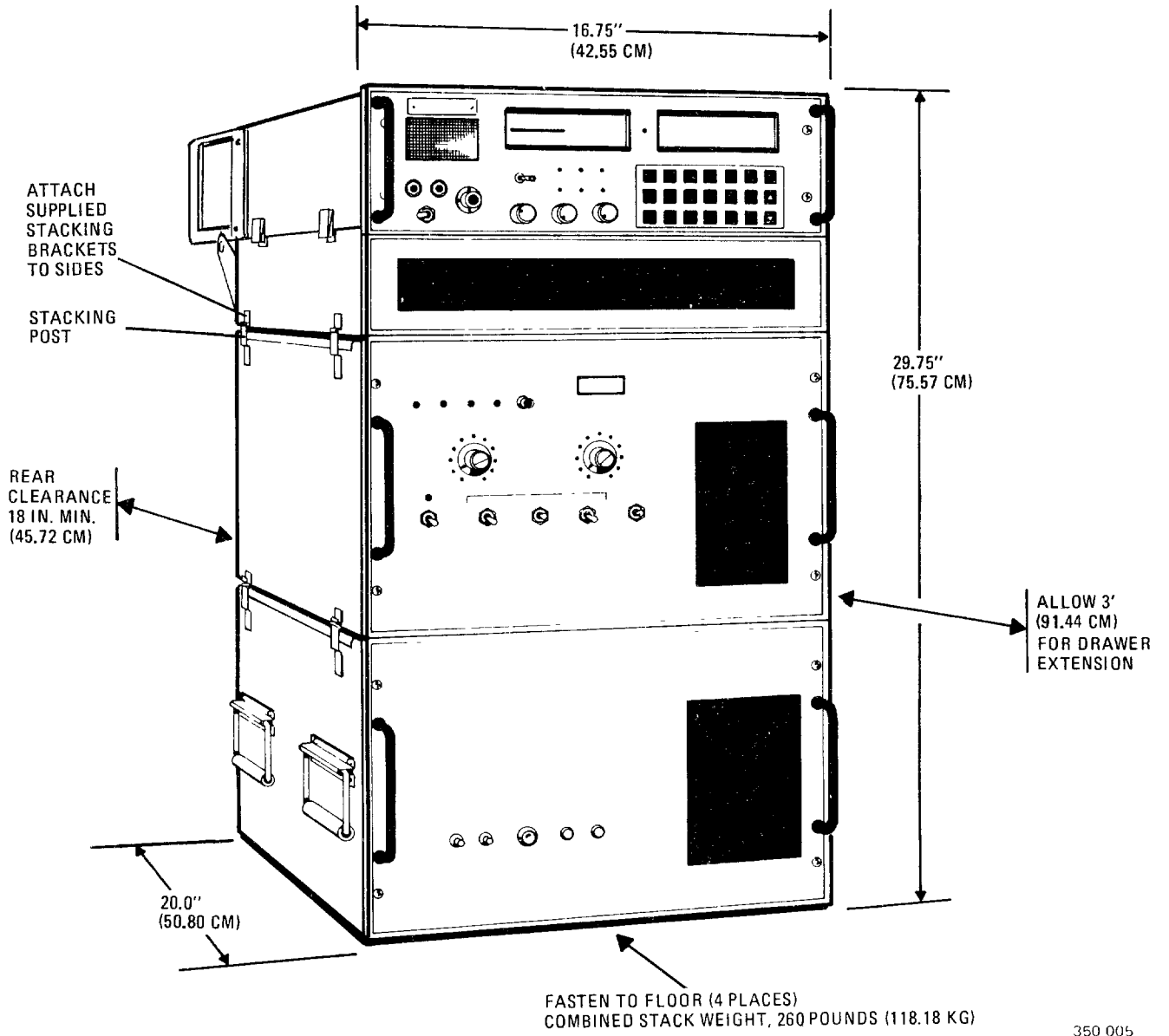

Figure 2-3. Typical Stack Mount Detail

## Section II. INSTALLATION PROCEDURE

**2-4. INSTALLING THE EQUIPMENT.** After unpacking the equipment and selecting the site, install the 1KW Power Supply as described in the following paragraphs.

a. Time Requirement. Installation should not take more than two hours.

b. Tool Requirements. Installation is accomplished with common hand tools, e.g., socket wrenches, screwdrivers, pliers, etc.

c. Personnel Requirements. Equipment positioning requires two individuals to lift and place the unit in position. Once the equipment is positioned and secured, one person can complete the installation in approximately 30 minutes.

**2-5. 1KW POWER SUPPLY MOUNTING INSTRUCTIONS.** The exact method of mounting the 1KW Power Supply depends upon the type of installation selected. Refer to figure 2-4 for 1KW Power Supply dimensions. Make sure that the mounting surface allows adequate room for the 1KW Power Supply and has proper clearance for cable interconnection.

**2-5-1. 1KW Power Supply Stack Mounting Instructions.**

- a. Refer to figure 2-4 for the 1KW Power Supply dimensions. Make sure that the mounting surface allows adequate room for ventilation intakes and outlets, and has proper clearance for cable interconnection.
- b. Install the stack mounting posts, using the hardware provided in the ancillary kit and the screw holes provided in the chassis of the 1KW Power Supply.
- c. Secure the 1KW Power Supply to the mounting surface, using appropriate hardware.

**2-5-2. 1KW Power Supply Rack Mounting Instructions.**

- a. Refer to figure 2-4 for the 1KW Power Supply dimensions. Make sure that the mounting surface allows adequate room for ventilation intakes and outlets, and has proper clearance for cable interconnection.

b. Install slide mounting brackets and slides, using the appropriate hardware.

c. Carefully lift the Power Supply and insert the slides in the mounting rack slide brackets. Ensure that the equipment is properly seated.

**2-6. CABLING CONNECTIONS.** After the equipment has been positioned and secured, fabricate and connect the 1KW Power Supply cables as described in the following paragraphs.

a. Interconnection and Interface. Standard cables should be used.

b. Cable Fabrication. Detailed information on cable fabrication is provided in table 2-1.

**CAUTION**

High voltage wire must be a separate shielded wire rated at 20 KV as shown in the fabrication procedure.

c. See figure 2-2 for primary power strapping information.

**2-7. CHECKING THE INSTALLATION.** After the 1KW Power Supply has been installed and interconnection cables are connected, verify that each item in the list below has been completed before applying power:

- a. All connectors are attached and tight.
- b. Ground wires are connected between the 1KW Power Supply and a known good ground. Examples of good grounds are a cold water pipe, a long copper stake pounded into solid earth, or a system ground bus at an existing site (refer to T.O. 31-10-24). A good ground is 10 ohms or less.
- c. Hardware for the equipment is securely tightened.
- d. Verify power supply primary power strapping according to figure 2-2.

After considering each item on the list above, the equipment may be considered ready for the application of power. Power application and initial equipment testing are discussed in chapter 3 of this manual.

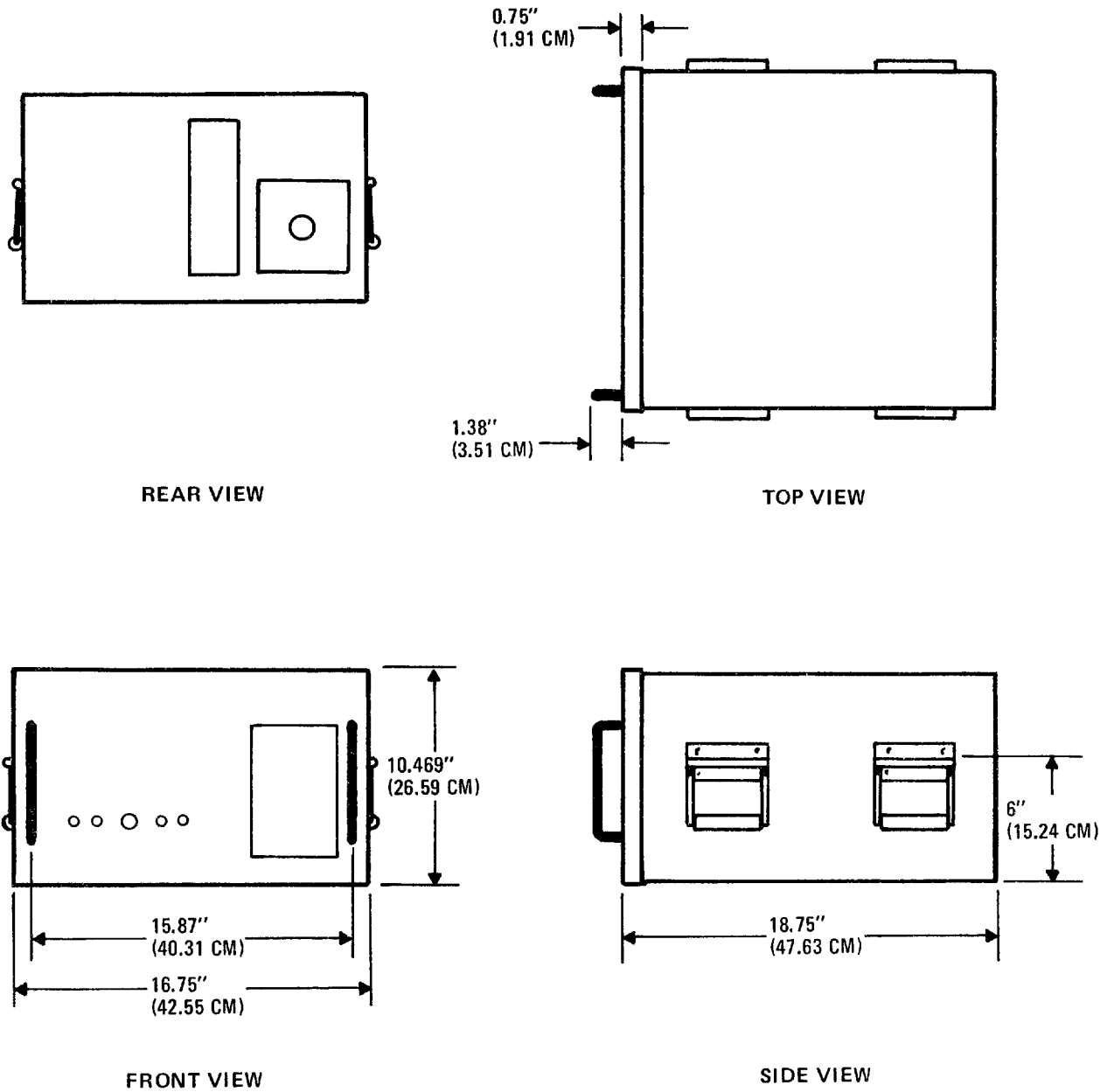

Figure 2-4. Dimensions

354-003

**Table 2-1. Interconnection Cabling Information**

|  |   |  |
|--|---|--|
| J1 Power (LPA end)<br>Mating connector<br>10087-0016 |   | J1 Power (Power Supply<br>end) Mating connector:<br>10087-0016 |
| J1-A   | Power-on Switch                         | J1-A   |
| J1-B   | High Voltage On                         | J1-B   |
| J1-C   | Spare                                   | J1-C   |
| J1-D   | Spare                                   | J1-D   |
| J1-E   | 115 VAC Filament                        | J1-E   |
| J1-F   | 115 VAC Filament                        | J1-F   |
| J1-G   | Ground                                  | J1-G   |
| J1-H   | Power-on Return (Ground)                | J1-H   |
| J1-J   | Ground                                  | J1-J   |
| J1-K   | +13.5 Vdc                               | J1-K   |
| J1-L   | B+ Sample                               | J1-L   |
| J1-M   | B+ 3000 Volts*                          | J1-M   |
| TB1 Input Power                                      |   |  |
| TB1-1  | 115/208/230 Vac (50, 60, 400 Hz) - Low  |  |
| TB1-2  | Chassis Ground                          |  |
| TB1-3  | 115/208/230 Vac (50, 60, 400 Hz) - High |  |
| TB2 Input Pwr Strapping (Reference only)             |   |  |
| TB2-1  | T1 (winding 1) - 130V tap               |  |
| TB2-2  | T1 (winding 1) - 115V tap               |  |
| TB2-3  | T1 (winding 1) - 105V tap               |  |
| TB2-4  | T1 (winding 1) - 0V common              |  |
| TB2-5  | T1 (winding 2) - 130V tap               |  |
| TB2-6  | T1 (winding 2) - 115V tap               |  |
| TB2-7  | T1 (winding 2) - 105V tap               |  |
| TB2-8  | T1 (winding 2) - 0V common              |  |
| TB2-9  | T2 (winding 1) - 115V tap               |  |
| TB2-10   | T2 (winding 1) - 0V common              |  |
| TB2-11   | T2 (winding 2) - 115V tap               |  |
| TB2-12   | T2 (winding 2) - 0V common              |  |
| TB2-13   | T2 (winding 2) - 93V tap                |  |

\* Requires high-voltage wire, 20 KV rated minimum.

**CHAPTER 3**  
**PREPARATION FOR USE AND RESHIPMENT**

---

**Section I. PREPARATION FOR USE**

**3-1. INITIAL CONTROL SETTINGS.** The 1KW Power Supply does not have any external controls. All control of the 1KW Power Supply is effected from the front panel of the associated 1 KW LPA or from the front panel of the companion 100 Watt Transceiver.

**3-2. INITIAL POWER APPLICATION.** The POWER ENABLE switch on the 1 KW LPA front panel controls power to the 1KW Power Supply. Upon completion of the steps listed below, the operator will have confirmed that the 1KW Power

Supply is ready for the checkout test procedure given in paragraph 3-4.

**3-3. STEP-BY-STEP SEQUENCE FOR INITIAL POWER APPLICATION.** Follow the procedure in paragraph 3-3 of the on-equipment manual for the 1 KW LPA, T.O. 31R2-2URC-121.

**3-4. INITIAL CHECKOUT.** Follow the procedure in paragraphs 3-4 and 3-5 of the on-equipment manual for the 1 KW LPA, T.O. 31R2-2URC-121.

**Section II. PREPARATION FOR RESHIPMENT**

**3-5. PREPARATION FOR RESHIPMENT.**

Use original packing materials.

Power Supply from its mounting. Retain mounting hardware for future installation.

**3-6. STEP-BY-STEP DISASSEMBLY PROCEDURE.**

- a. Ensure that all power sources associated with the 1KW Power Supply are shut down.
- b. Disconnect all interface cables and grounding straps from the 1KW Power Supply.
- c. Replace plastic dust cover caps over 1KW Power Supply connectors.
- d. Unbolt mounting hardware and remove the 1KW

**3-7. STEP-BY-STEP PACKING AND CRATING PROCEDURE.**

- a. Refer to figure 2-1. Repackage all of the interface cables and mounting hardware associated with the 1KW Power Supply in the original (or an equivalent) container.
- b. Place the ancillary cables and mounting hardware into the container along with the 1KW Power Supply.
- c. Close and bind the container.

**CHAPTER 4****OPERATION**

---

**Section I. CONTROLS AND INDICATORS**

**4-1. INTRODUCTION.** The 1KW Power Supply has no external operating controls, and only one indicator. Its operation is automatically performed upon initiation of control signals from the associated 100 Watt Transceiver or 1 KW LPA. If there is any reason to suspect a problem in the 1KW Power Supply, refer to the 1 KW LPA on-equipment manual, T.O. 31R2-2URC-121, chapter 6, paragraph 6-7 and table 6-2, and initiate the BIT test sequence. Figure 4-1 shows the 1 KW Power Supply front panel.

**4-2. INDICATIONS OF NORMAL OPERATION.**

a. Power ON. When the 1KW Power Supply is

connected to the 1KW Linear Power Amplifier and to a 100 Watt Transceiver, the front panel POWER ON indicator will come on and the fan will run when power on is commanded from the 100 Watt Transceiver. This command is +13.5 Vdc from the 100 Watt Transceiver, through an ENABLE switch on the 1KW LPA front panel and through unit interlocks. There are two unit interlocks on the 1KW Power Supply, one on the cover and the other on the access panel covering the primary power strapping terminal board at the rear of the unit.

b. HV ON. High Voltage ON is also commanded from the 1KW LPA. The HV ON indicator is on the 1KW LPA.

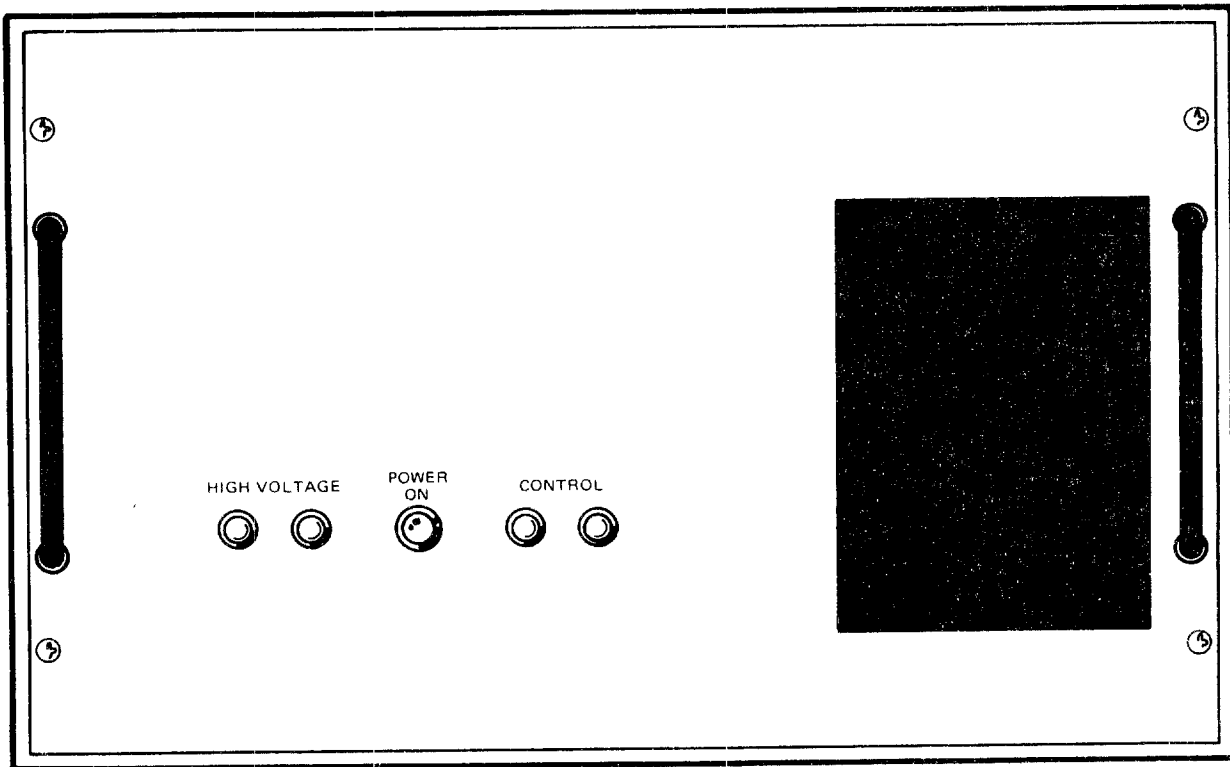

354-004

Figure 4-1. Operating Controls and Indicators

**Section II. OPERATING INSTRUCTIONS**

**4-3. INTRODUCTION.** Refer to chapter 4, section 2, of the 1 KW LPA On-Equipment Manual,

T.O. 31R2-2URC-121, for instructions that will initiate automatic operation of the 1KW Power Supply.



## CHAPTER 5

### THEORY OF OPERATION

**5-1. GENERAL DESCRIPTION.** The 1KW Power Supply is a 115/208/230 Vac, 50/60/400 Hz, single-phase power supply that produces three output voltages: +3000 Vdc power amplifier plate supply at up to 1 ampere; +13.5 Vdc at up to 8 amperes; and 115 Vac at up to 1 ampere. See the schematic diagram FO-1 in chapter 8 for the discussion that follows.

**5-2. PRIMARY POWER STRAPPING.** Primary power from the source terminates at TB1 on the rear of the unit. The source should be capable of delivering up to 4000 volt-amps.. This means that at 208 Vac, connections to TB1 should be capable of handling 20 amperes; at 230 Vac, 18 amperes; and at 115 Vac, 40 amperes. TB1 and TB2 have protective covers. The metal plate covering TB2 activates an interlock (S1) in the primary power control circuit. With this interlock open, primary power control relay K2 cannot be activated and the circuit from TB1 to TB2 cannot be completed.

**WARNING**

Always verify that primary power has been removed at the source before making any TB1 terminal board wiring changes.

Figure 2-2 gives strapping information for TB1 as a function of the normal input voltage.

**5.3 POWER ON CONTROL** With primary power present at TB1, the 13.5 Vdc supply can be energized by providing both 13.5 Vdc at J1-A and 13.5 Vdc return at J1-H. With both interlocks S1 and

S2 closed, relay K2 will be energized and complete the primary power circuit through terminal strip TB2 to low voltage transformer T2 (assuming CB1 and CB2 are closed).

**5.4 115 VAC FILAMENT SUPPLY.** Transformer T2 acts as an autotransformer supplying 115 Vac to connector pins J1-E and J1-F for use as filament voltage by the 1 KW LPA. Front panel lamp DS1 is also illuminated by this 115 Vac.

**5.5 13.5 VDC SUPPLY.** The 13.5 VDC Supply uses the center-tapped output of transformer T2 in a full-wave rectifier circuit to produce the 13.5 Vdc output. Capacitor C2 provides filtering and resistor R6 is the bleeder. The power supply cooling fan B1 is connected across this output and is activated when the 13.5 Vdc output is activated. This voltage will also be present as an enabling voltage at the HV ON contactor K1.

**5.6 HIGH VOLTAGE SUPPLY.** Primary power is applied to the high voltage transformer T1 through contactor K1 and terminal strip TB2. Contactor K1 is activated by a ground signal applied to connector pin J1-B. The high voltage secondary is connected in a full-wave bridge choke input filter configuration to provide the nominal +3000 Vdc high voltage output. Rectifiers CR1 through CR4 form the full-wave bridge circuit, while choke L1 and capacitor C1 form the filter network. Resistors R1 through R3 provide both a bleeder action and a divider circuit to supply a B+ sample through resistor R4 and capacitor C3 to the bias circuit of the power amplifier tube in the 1KW LPA. Switch S2 is a mechanically operated crowbar that shorts the +3000 Vdc output to ground as a safety measure when the cover is removed.



## CHAPTER 6

### MAINTENANCE

---

**WARNING**

Dangerous voltages exist in this radio equipment. Remove power and wait 30 seconds for dangerous voltages to bleed off before removing any covers.

**6-1. GENERAL.** There are no adjustments in the 1KW Power Supply. Field maintenance for the 1KW Power Supply is limited to replacing the components identified in Chapter 7, Illustrated Parts Breakdown. Refer also to the troubleshooting procedures in Chapter 6 of the On-equipment Manual for the 1KW Linear Power Amplifier (T.O. 31R2-2URC-121).

**6-2. PERIODIC MAINTENANCE.** The 1KW Power Supply requires only a limited amount of periodic maintenance. The following actions are recommended at the intervals listed. During any of the specific procedures listed, take note of any unusual equipment conditions which may indicate degrading or degraded performance, and make the necessary corrections.

#### NOTE

**Field and Organizational Maintenance of the modules and circuit card assemblies is limited to the removal, replacement, and alignments given in Chapter 6.**

#### Tool List

Screwdriver:

3/16-inch flat blade (4 inches long)

a. Clean Air Filter. Clean the equipment air filter every 14 days for 24-hour continuous equipment operation, or sooner if filter is noticeably soiled. Use soap and water; dry thoroughly before replacing.

b. Dust Accumulation. At 28-day intervals, check the interior of the power supply for dust accumulation. Remove any excessive dust accumulation as required.



## CHAPTER 7

### ILLUSTRATED PARTS BREAKDOWN

#### Section 1. INTRODUCTION

**7-1. PURPOSE.** This chapter lists, illustrates, and describes the detail parts for the 1 KW Power Supply. Its purpose is for the identification, requisitioning, and issuance of parts at the organizational (on-equipment) level.

**7-2. SCOPE.** Only parts that are coded as replaceable at the organizational level are listed in this chapter. These include the major detail parts. Mounting hardware is listed only if it is used to attach a replaceable detail part and only if it is not held captive to the part. In general, the parts installed at the time the 1 KW Power Supply was manufactured are listed and identified in this chapter. When a part (including vendor items), which is different from the original, was installed during the manufacture of later items, series, or blocks, all parts are listed (and "Usable-On" coded). However, when the original part does not have continued application (no spares of the original were procured or such spares are no longer authorized for replacement), only the preferred part is listed. Also, when a part was installed during modification, and the original does not have continued application, only the preferred item is listed. Interchangeable and substitute parts, subsequently authorized by the Government, are not listed in this chapter; such items are identified by information available through the Interchangeable and Substitute (I & S) Data Systems. Refer to T.O. 00-25-184. When a standard size part

can be replaced with an oversize or undersize part, the latter parts, showing sizes, are also listed. Repair Parts Kits and Quick Change Units are listed when they are available for replacement.

**7-3. CHAPTER ORGANIZATION.** This chapter is divided into two sections. Section I, INTRODUCTION, explains the purpose, scope, and organization of the chapter. Section II, MAINTENANCE PARTS LIST, consists of illustrations, in which the detail parts of the 1 KW Power Supply are identified by numbers (called index numbers), followed by lists which contain parts numbers, descriptions, and other relevant data for the items identified on the illustrations.

**7-4. SOURCE, MAINTENANCE, AND RECOVERABILITY (SMR) CODES.** This chapter contains Air Force Peculiar In-Being Source and Repair Codes only. Definitions of these SMR codes, as well as detailed coding criteria and transposition matrices for each coding method, may be obtained from T.O. 00-25-195. Refer to page 7-3.

**7.5. FEDERAL SUPPLY CODES FOR MANUFACTURERS (FSCM).** The codes used in this chapter are as follows. The first list is in numerical order by FSCM; the second is in alphabetical order by manufacturer name.

**T.O. 35C1-2-892-1**

| <b>FSCM</b> | <b>NAME AND ADDRESS</b>  | <b>FSCM</b> | <b>NAME AND ADDRESS</b>  | <b>FSCM</b> | <b>NAME AND ADDRESS</b>  | <b>FSCM</b> |
|-------------|--|-------------|--|-------------|--|-------------|
| 00758       | Neilson Products Company<br>Lake Elmo, Minnesota   | 77342       | AMF Incorporated<br>Potter and Brumfield Division<br>200 Richland Creek Drive<br>Princeton, Indiana 47671  |             | Loctite Corporation<br>705 North Mountain Road<br>Newington, Connecticut 06111   | 05972       |
| 05972       | Loctite Corporation<br>705 North Mountain Road<br>Newington, Connecticut 06111   | 81349       | Military Specification Code  |             | Magna Division<br>Vermont American Corporation<br>1001 West Park Road<br>Elizabethtown, Kentucky 42701                                 | 11195       |
| 06540       | Mite Corporation<br>Amatom Electronic Hardware Division<br>446 Blake Street<br>New Haven, Connecticut 06515                                      | 82877       | Rotron Incorporated<br>Custom Division<br>7 Hasbrouck Lane<br>Woodstock, New York 12498  |             | Mite Corporation<br>Amatom Electronic Hardware Division<br>446 Blake Street<br>New Haven, Connecticut 06515                            | 06540       |
| 09023       | Cornell-Dubilier Electronics<br>118 East Jones Street<br>Fuquay-Varina, North Carolina 27526   | 88325       | Aircraft Accessories Corporation<br>Burbank, California  |             | Neilson Products Company<br>Lake Elmo, Minnesota   | 00758       |
| 09166       | Stone City Products Inc.<br>1206 7th Street<br>P.O. Box 369<br>Bedford, Indiana 47421  | 96906       | Military Specification Code  |             | Rotron Incorporated<br>Custom Division<br>7 Hasbrouck Lane<br>Woodstock, New York 12498  | 82877       |
| 10026       | CSI Capacitors<br>A Division of CSI Technologies<br>Incorporated<br>Del Dios Highway<br>P.O. Box 2052<br>Escondido, California 92025             | 97520       | Basler Electric Company<br>Route 143<br>P.O. Box 269<br>Highland, Illinois 62249   |             | Sprague Electric Company<br>87 Marshall Street<br>North Adams, Massachusetts 01247   | 56289       |
| 11195       | Magna Division<br>Vermont American Corporation<br>1001 West Park Road<br>Elizabethtown, Kentucky 42701   |             | <b>NAME AND ADDRESS</b>  | <b>FSCM</b> | Stone City Products Inc.<br>1206 7th Street<br>P.O. Box 369<br>Bedford, Indiana 47421  | 09166       |
| 12697       | Clarostat Manufacturing Company<br>Incorporated<br>Lower Washington Street<br>Dover, New Hampshire 03820   |             | Aircraft Accessories Corporation<br>Burbank, California  | 88325       | Thomas and Betts Corporation<br>Highway 218 South<br>Iowa City, Iowa 52240   | 59730       |
| 14304       | Harris Corporation<br>RF Communications Group<br>1680 University Avenue<br>Rochester, New York 14610   |             | AMF Incorporated<br>Potter and Brumfield Division<br>200 Richland Creek Drive<br>Princeton, Indiana 47671  | 77342       | Varo Semiconductor Incorporated<br>Subsidiary of Varo Incorporated<br>1000 North Shiloh Road<br>P.O. Box 40676<br>Garland, Texas 75040 | 62703       |
| 51144       | IDI Electric Canada Limited<br>33 Fuller Road<br>Box 159<br>Ajax, Ontario, Canada L1S 2E1  |             | Basler Electric Company<br>Route 143<br>P.O. Box 269<br>Highland, Illinois 62249   | 97520       |  |             |
| 56289       | Sprague Electric Company<br>87 Marshall Street<br>North Adams, Massachusetts 02147   |             | Carborundum Corporation<br>The Electrical Products Division<br>Global Plant<br>3425 Hyde Park Blvd.<br>P.O. Box 339<br>Niagara Falls, New York 14302 | 72819       |  |             |
| 59730       | Thomas and Betts Corporation<br>Highway 218 South<br>Iowa City, Iowa 52240   |             | Clarostat Manufacturing Company<br>Incorporated<br>Lower Washington Street<br>Dover, New Hampshire 03820   | 12697       |  |             |
| 59993       | International Rectifier<br>Semiconductor Division<br>233 Kansas Street<br>El Segundo, California 90245   |             | Cornell-Dubilier Electronics<br>118 East Jones Street<br>Fuquay-Varina, North Carolina 27526   | 09023       |  |             |
| 62703       | Varo Semiconductor Incorporated<br>Subsidiary of Varo Incorporated<br>1000 North Shiloh Road<br>P.O. Box 40676<br>Garland, Texas 75040           |             | CSI Capacitors<br>A Division of CSI Technologies<br>Incorporated<br>Del Dios Highway<br>P.O. Box 2052<br>Escondido, California 92025                 | 10026       |  |             |
| 72794       | DZUS Fastener Company Inc.<br>425 Union Blvd.<br>West Islip, New York 11795  |             | DZUS Fastener Company Inc.<br>425 Union Blvd.<br>West Islip, New York 11795  | 72794       |  |             |
| 72819       | Carborundum Company<br>The Electrical Products Division<br>Global Plant<br>3425 Hyde Park Blvd.<br>P.O. Box 339<br>Niagara Falls, New York 14302 |             | Harris Corporation<br>RF Communications Group<br>1680 University Avenue<br>Rochester, New York 14610   | 14304       |  |             |
|             |  |             | IDI Electric Canada Limited<br>33 Fuller Road<br>Box 159<br>Ajax, Ontario, Canada L1S 2E1  | 51144       |  |             |
|             |  |             | International Rectifier<br>Semiconductor Division<br>233 Kansas Street<br>El Segundo, California 90245   | 59993       |  |             |

Note: Field and organizational maintenance of the modules and circuit card assemblies is limited only to the removals, replacements, and alignments given in chapter 6.

JOINT MILITARY SERVICES UNIFORM SMR CODING MATRIX T.O. 00-25-195

| SOURCE       |                              | MAINTENANCE USE |                                     | REPAIR       |  | RECOVERABILITY |                                   | ERRC CODE    |  |              |   |
|--------------|------------------------------|-----------------|-------------------------------------|--------------|--|----------------|-----------------------------------|--------------|--|--------------|---|
| 1st Position |                              | 2nd Position    |                                     | 3rd Position |  | 4th Position   |                                   | 5th Position |  | 6th Position |   |
| P            | Procurable                   | A               | Stocked                             | O            | Remove/<br>Replace at<br>Organizational<br>Level | Z              | No Repair                         | Z            | Nonreparable<br>Condemn at 3rd<br>Position Level | N            | Nonrecoverable XB3<br>Condemn at Any Level                                    |
|              |                              | B               | Insurance                           |              |  |                |                                   |              |  |              |   |
|              |                              | C               | Deteriorative                       |              |  |                |                                   |              |  |              |   |
|              |                              | E               | Support<br>Equipment,<br>Stocked    |              |  |                |                                   |              |  |              |   |
|              |                              | F               | Support<br>Equipment,<br>Nonstocked |              |  |                |                                   |              |  |              |   |
|              |                              | G               | Sustained<br>Life Support           |              |  |                |                                   |              |  |              |   |
| K            | Component of a<br>Repair Kit | F               | Intermediate Kit                    | F            | Remove/<br>Replace at Inter-<br>mediate Level    | O              | Repair at<br>Organizational       | F            | Reparable<br>Condemn at<br>Intermediate          | T            | Recoverable XD2<br>Condemn at Depot   |
|              |                              | D               | Depot Kit                           |              |  |                |                                   |              |  |              |   |
|              |                              | B               | In Both Kits                        |              |  |                |                                   |              |  |              |   |
| M            | Manufacture                  | O               | Organization                        | D            | Remove/Replace at<br>Depot Level                 | D              | Limited Repair at<br>O or F Level | D            | Reparable<br>Condemn at Depot                    | S            | Nonexpendable Support<br>Equipment, Depot ND2                                 |
|              |                              | F               | Intermediate                        |              |  |                |                                   |              |  |              |   |
|              |                              | D               | Depot                               |              |  |                |                                   |              |  |              |   |
| A            | Assemble                     | O               | Organization                        | D            | Remove/Replace at<br>Depot Level                 | D              | Overhaul at<br>Depot              | D            | Reparable<br>Condemn at Depot                    | U            | Nonexpendable Support<br>Equipment,<br>Organizational and<br>Intermediate NF2 |
|              |                              | F               | Intermediate                        |              |  |                |                                   |              |  |              |   |
|              |                              | D               | Depot                               |              |  |                |                                   |              |  |              |   |
| X            | Nonprocured                  | A               | Requisition NHA                     | D            | Remove/Replace at<br>Depot Level                 | L              | Repair at Depot                   | A            | Special Handling                                 | U            | Nonexpendable Support<br>Equipment,<br>Organizational and<br>Intermediate NF2 |
|              |                              | B               | Reclamation<br>from IM              |              |  |                |                                   |              |  |              |   |
|              |                              | C               | Mfg Drawings                        |              |  |                |                                   |              |  |              |   |

Section II. MAINTENANCE PARTS LIST

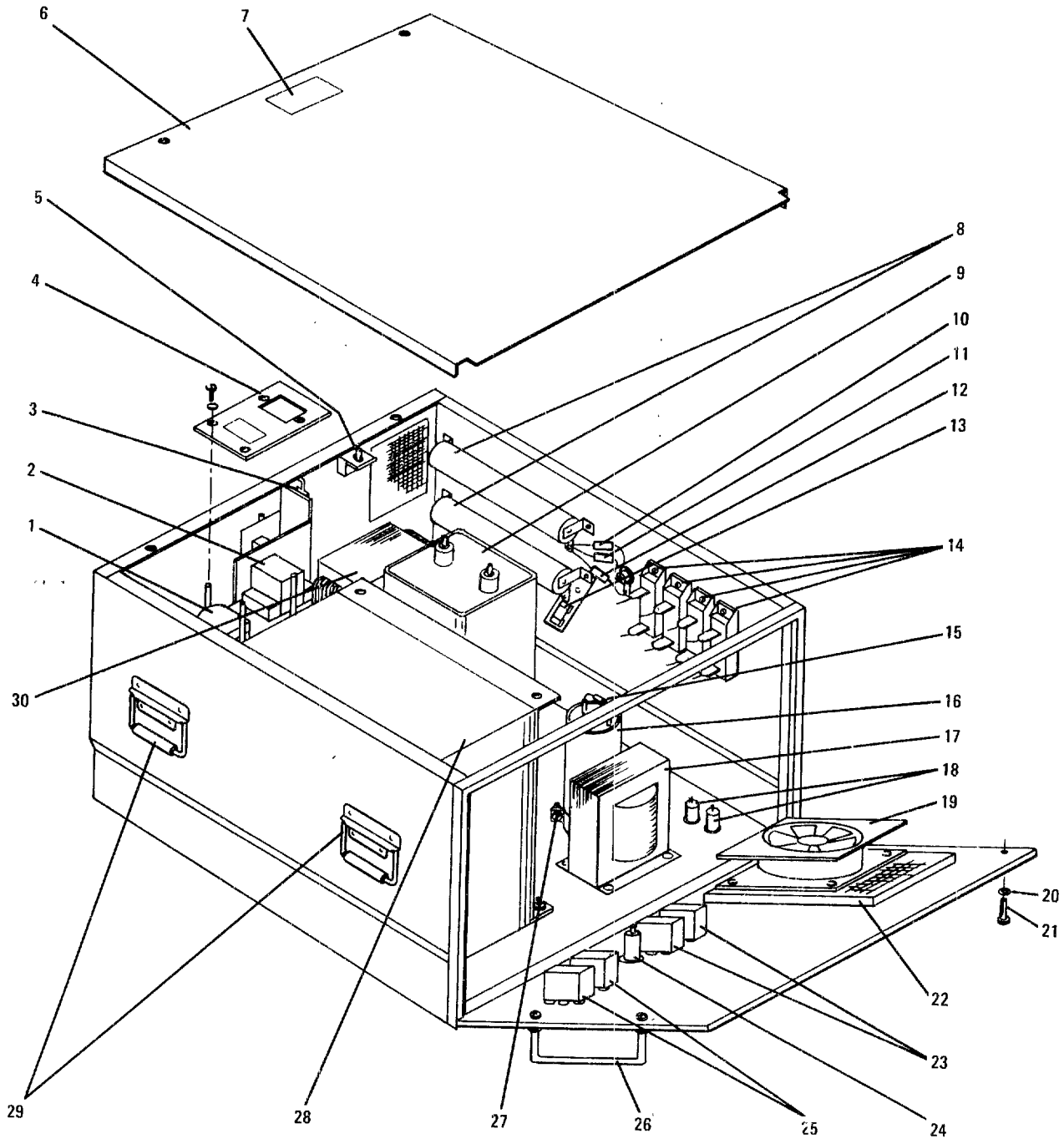

354-008

Figure 7-1. 1 KW Power Supply, PP-7913/URC

## ILLUSTRATED PARTS BREAKDOWN

| Fig. & Index No. | Part No.        | FSCM  | Description<br>1 2 3 4 5 6 7 | Units Per Assy | Usable on Code | SMR Code |
|------------------|-----------------|-------|------------------------------|----------------|----------------|----------|
| 7-1-             | 10087-5000      | 14304 | Power Supply                 |                |                | PAODD    |
| 1                | W389CX-7        | 11195 | . Relay                      | 1              |                | PAOZZ    |
|                  | H-6768          | 96906 | . Nut, Keps (AP)             | 20             |                | XB       |
|                  | MS15795-806     | 96906 | . Washer, Flat (AP)          | 9              |                | PAOZZ    |
| 2                | P25P44D32P112   | 77342 | . Relay                      | 1              |                | PAOZZ    |
|                  | MS51958-67      | 96906 | . Screw, Machine (AP)        | 2              |                | PAOZZ    |
|                  | MS15795-807     | 96906 | . Washer, Flat (AP)          | 6              |                | PAOZZ    |
| 3                | MS16106-4       | 96906 | . Switch                     | 2              |                | PAOZZ    |
|                  | MS51958-13      | 96906 | . Screw, Machine (AP)        | 4              |                | PAOZZ    |
|                  | MS35338-135     | 96906 | . Washer, Lock (AP)          | 6              |                | PAOZZ    |
| 4                | 10087-5104      | 14304 | . Cover, Relay               | 1              |                | XB       |
|                  | MS51957-29      | 96906 | . Screw, Machine (AP)        | 4              |                | PAOZZ    |
|                  | MS35338-136     | 96906 | . Washer, Lock (AP)          | 5              |                | PAOZZ    |
|                  | MS15795-805     | 96906 | . Washer, Flat (AP)          | 11             |                | PAOZZ    |
|                  | MP-0745         | 14304 | . Label, Warning             | 2              |                | MDO      |
| 5                | 10087-5224      | 14304 | . Switch Assy                | 1              |                | XB       |
|                  | MS51957-14      | 96906 | . Screw, Machine (AP)        | 2              |                | PAOZZ    |
|                  | MS35338-135     | 96906 | . Washer, Lock (AP)          | Ref.           |                | PAOZZ    |
|                  | MS15795-803     | 96906 | . Washer, Flat (AP)          | 2              |                | PAOZZ    |
| 6                | 10087-3104      | 14304 | . Cover, Power Supply        | 1              |                | XB       |
|                  | AJ4-35-SS       | 72794 | . Stud, Retainer (AP)        | 2              |                | XB       |
|                  | SR-4-SS         | 72794 | . Retainer (AP)              | 2              |                | XB       |
| 7                | 10087-5010      | 14304 | . Label, Danger              | 1              |                | MDO      |
| 8                | RW38V271        | 81349 | . Resistor                   | 2              |                | PAOZZ    |
|                  | MS51957-28      | 96906 | . Screw, Machine (AP)        | 1              |                | PAOZZ    |
|                  | MS35338-136     | 96906 | . Washer, Lock (AP)          | Ref.           |                | PAOZZ    |
|                  | MS51957-30      | 96906 | . Screw, Machine (AP)        | 5              |                | PAOZZ    |
|                  | H-6768          | 96906 | . Nut, Keps (AP)             | Ref.           |                | XB       |
| 9                | 4N322TNP        | 10026 | . Capacitor, Fxd, Paper      | 1              |                | PAOZZ    |
|                  | 1020F251        | 09166 | . Bracket, Mtg., Cap (AP)    | 2              |                | XB       |
|                  | TC-105A         | 59730 | . Base (AP)                  | 1              |                | XB       |
|                  | H-6768          | 96906 | . Nut, Keps (AP)             | Ref.           |                | XB       |
|                  | MP-0745         | 14304 | . Label, Warning             | Ref.           |                | MDO      |
| 10               | M39003/01-3100  | 81349 | . Capacitor, Fxd.Elett.      | 1              |                | PAOZZ    |
| 11               | RCR32G392JS     | 81349 | . Resistor, Fixed            | 1              |                | PAOZZ    |
| 12               | RWR74S1621FS    | 81349 | . Resistor, Fixed            | 1              |                | PAOZZ    |
| 13               | 885SP220L       | 72819 | . Resistor, Fixed            | 1              |                | PAOZZ    |
| 14               | VC80            | 62703 | . Semicond Device, DIO       | 4              |                | PAOZZ    |
|                  | MS51957-31      | 96906 | . Screw, Machine (AP)        | 8              |                | PAOZZ    |
|                  | MS15795-806     | 96906 | . Washer, Flat (AP)          | Ref.           |                | PAOZZ    |
|                  | H-6768          | 96906 | . Nut, Keps (AP)             | Ref.           |                | XB       |
| 15               | RCR32G102JS     | 81349 | . Resistor, Fixed            | 1              |                | PAOZZ    |
| 16               | 3120EE383U025AM | 56289 | . Cap, Fxd, Elctlt           | 1              |                | PAOZZ    |
|                  | MS51957-30      | 96906 | . Screw, Machine (AP)        | Ref.           |                | PAOZZ    |
|                  | MS15795-805     | 96906 | . Washer, Flat (AP)          | Ref.           |                | PAOZZ    |
| 17               | 10087-5110      | 14304 | . Transformer, RF            | 1              |                | PAOZZ    |
|                  | 10043-0039      | 14304 | . Resistor, Network          | 2              |                | PAOZZ    |
|                  | MS15795-807     | 96906 | . Washer, Flat (AP)          | Ref.           |                | PAOZZ    |
|                  | H-6767          | 96906 | . Nut, Keps (AP)             | 4              |                | XB       |
| 18               | 70HFR20         | 59993 | . Semicond Device, DIO       | 2              |                | PAOZZ    |

**ILLUSTRATED PARTS BREAKDOWN  
(Continued)**

| Fig. & Index No. | Part No.        | FSCM  | Description |                         |   |   |   |   |   | Units Per Assy | Usable on Code | SMR Code |
|------------------|-----------------|-------|-------------|-------------------------|---|---|---|---|---|----------------|----------------|----------|
|                  |                 |       | 1           | 2                       | 3 | 4 | 5 | 6 | 7 |                |                |          |
| 19               | 028868          | 82877 | .           | Fan                     |   |   |   |   |   | 1              |                | PAOZZ    |
|                  | MS15795-805     | 96906 | .           | Washer, Flat (AP)       |   |   |   |   |   | Ref.           |                | PAOZZ    |
|                  | H-6768          | 96906 | .           | Nut, Keps (AP)          |   |   |   |   |   | Ref.           |                | XB       |
| 20               | 10087-2011      | 14304 | .           | Washer, Flat            |   |   |   |   |   | 4              |                | PAOZZ    |
| 21               | 10087-2012      | 14304 | .           | Screw, Machine          |   |   |   |   |   | 4              |                | PAOZZ    |
| 22               | 10087-2010      | 14304 | .           | Filter, Air             |   |   |   |   |   | 1              |                | PAOZZ    |
| 23               | W58XB1A6A-2     | 77342 | .           | Circuit Brkr            |   |   |   |   |   | 2              |                | PAOZZ    |
| 24               | 1050QA3         | 51144 | .           | Lamp                    |   |   |   |   |   | 1              |                | PAOZZ    |
| 25               | W58XB1A6A-20    | 77342 | .           | Circuit Brkr            |   |   |   |   |   | 2              |                | PAOZZ    |
| 26               | 10353-B-1032-6A | 06540 | .           | Handle, Bow             |   |   |   |   |   | 2              |                | XB       |
|                  | MS24693-C273    | 96906 | .           | Screw, Machine (AP)     |   |   |   |   |   | 4              |                | PAOZZ    |
|                  | 16022-A2        | 06540 | .           | Bushing (AP)            |   |   |   |   |   | 4              |                | XB       |
| 27               | 34775-2         | 09023 | .           | Bracket, Mtg. Cap. (AP) |   |   |   |   |   | 1              |                | XB       |
|                  | MS51958-64      | 96906 | .           | Screw, Machine (AP)     |   |   |   |   |   | 1              |                | PAOZZ    |
| 28               | H-6766          | 96906 | .           | Nut, Keps (AP)          |   |   |   |   |   | 5              |                | XB       |
|                  | BE1608001       | 97520 | .           | Transformer             |   |   |   |   |   | 1              |                | PAOLD    |
|                  | MS51957-83      | 96906 | .           | Screw, Machine (AP)     |   |   |   |   |   | 4              |                | PAOZZ    |
| 29               | MS35338-139     | 96906 | .           | Washer, Lock (AP)       |   |   |   |   |   | 4              |                | PAOZZ    |
|                  | MS15795-811     | 96906 | .           | Washer, Flat (AP)       |   |   |   |   |   | 4              |                | PAOZZ    |
|                  | 985             | 00758 | .           | Handle, Lift            |   |   |   |   |   | 4              |                | XB       |
|                  | MS51957-44      | 96906 | .           | Screw Machine (AP)      |   |   |   |   |   | 16             |                | PAOZZ    |
|                  | H-6767          | 96906 | .           | Nut, Keps (AP)          |   |   |   |   |   | Ref.           |                | XB       |
| 30               | P6527           | 88325 | .           | Transformer             |   |   |   |   |   | 1              |                | PAOZZ    |
|                  | MS15795-808     | 96906 | .           | Washer, Flat (AP)       |   |   |   |   |   | 4              |                | PAOZZ    |
|                  | H-6766          | 96906 | .           | Nut, Keps (AP)          |   |   |   |   |   | Ref.           |                | XB       |

**REFERENCE DESIGNATOR INDEX**

| Reference Designator | Figure & Index No. | Part Number     | Reference Designator | Figure & Index No. | Part Number  |
|----------------------|--------------------|-----------------|----------------------|--------------------|--------------|
| B1                   | 7-1-1              | 028868          | L1                   | 7-1-1              | P6527        |
| C1                   | 7-1-1              | 4N322TNP        | R1, R2               | 7-1-1              | RW38V271     |
| C2                   | 7-1-1              | 3120EE383U025AM | R3                   | 7-1-1              | RWR74S1621FS |
| C3                   | 7-1-1              | M39003/01-3100  | R4                   | 7-1-1              | RCR32G392JS  |
| CB1, CB2             | 7-1-1              | W58XB1A6A-2     | R5                   | 7-1-1              | 885SP220L    |
| CB3, CB4             | 7-1-1              | W58XB1A6A-20    | R6                   | 7-1-1              | RCR32G102JS  |
| CR1-CR4              | 7-1-1              | VC80            | RV1, RV2             | 7-1-1              | 10043-0039   |
| CR5, CR6             | 7-1-1              | 70HFR20         | S1, S3               | 7-1-1              | MS16106-4    |
| DS1                  | 7-1-1              | 1050QA3         | S2                   | 7-1-1              | 10087-5224   |
| K1                   | 7-1-1              | P25P44D32P112   | T1                   | 7-1-1              | BE1608001    |
| K2                   | 7-1-1              | W389CX-7        | T2                   | 7-1-1              | 10087-5110   |

CHAPTER 8  
FOLDOUT DRAWINGS

---

LIST OF 1KW POWER SUPPLY FOLDOUT DRAWINGS

FO-1 1 KW Power Supply Schematic Diagram



NOTE: UNLESS OTHERWISE SPECIFIED:

1. PARTIAL REFERENCE DESIGNATIONS ARE SHOWN FOR DETAIL PARTS. PREFIX THESE WITH UNIT NO. AND/OR ASSEMBLY DESIGNATIONS SHOWN ON DRAWING TO OBTAIN COMPLETE DESIGNATIONS.
2. ALL RESISTOR VALUES ARE IN OHMS, 1/4W, ±5%.
3. ALL CAPACITOR VALUES ARE IN MICROFARADS (UF).
4. ALL INDUCTANCE VALUES ARE IN MILLIHENRIES (MH).
5. VENDOR PART NO. CALLOUTS ARE FOR REFERENCE ONLY. COMPONENTS ARE SUPPLIED PER PART NO. IN PARTS LIST.
6. DC RESISTANCES OF INDUCTIVE ELEMENTS (CHOKES, COILS, MOTOR WINDINGS, ETC.) ARE LESS THAN 1 OHM.
7. PANEL DECALS ARE INDICATED BY BOLD TYPE IN A BOLD BOX, E.G., **ON/OFF**.
8. ALL RELAYS ARE SHOWN IN THE DE-ENERGIZED STATE.
9. CONNECTIONS SHOWN ARE FOR 230 VAC PRIMARY LINE VOLTAGE. FOR OTHER VOLTAGES, CONNECT WIRES AND JUMPERS AT TB2 AS PER THE FOLLOWING TABLE:

| VOLTAGE | #14 AWG | JUMP1 | JUMP2 | JUMP3 | JUMP4 |
|---------|---------|-------|-------|-------|-------|
| 115     | 3       | 2-6   | 4-8   | 9-11  | 10-12 |
| 208     | 2       | 4-7   | NONE  | 10-13 | NONE  |
| 230     | 3       | 4-6   | NONE  | 10-11 | NONE  |

| HIGHEST REFERENCE DESIGNATION   |    |     |     |     |
|---------------------------------|----|-----|-----|-----|
| B1                              | C3 | CB4 | CR6 | DS1 |
| J1                              | K2 | LI  | R6  | RV2 |
| REFERENCE DESIGNATIONS NOT USED |    |     |     |     |
| E5                              | P3 |     |     |     |

| HIGHEST REFERENCE DESIGNATION   |    |     |
|---------------------------------|----|-----|
| S3                              | T2 | TB2 |
| REFERENCE DESIGNATIONS NOT USED |    |     |
|                                 |    |     |

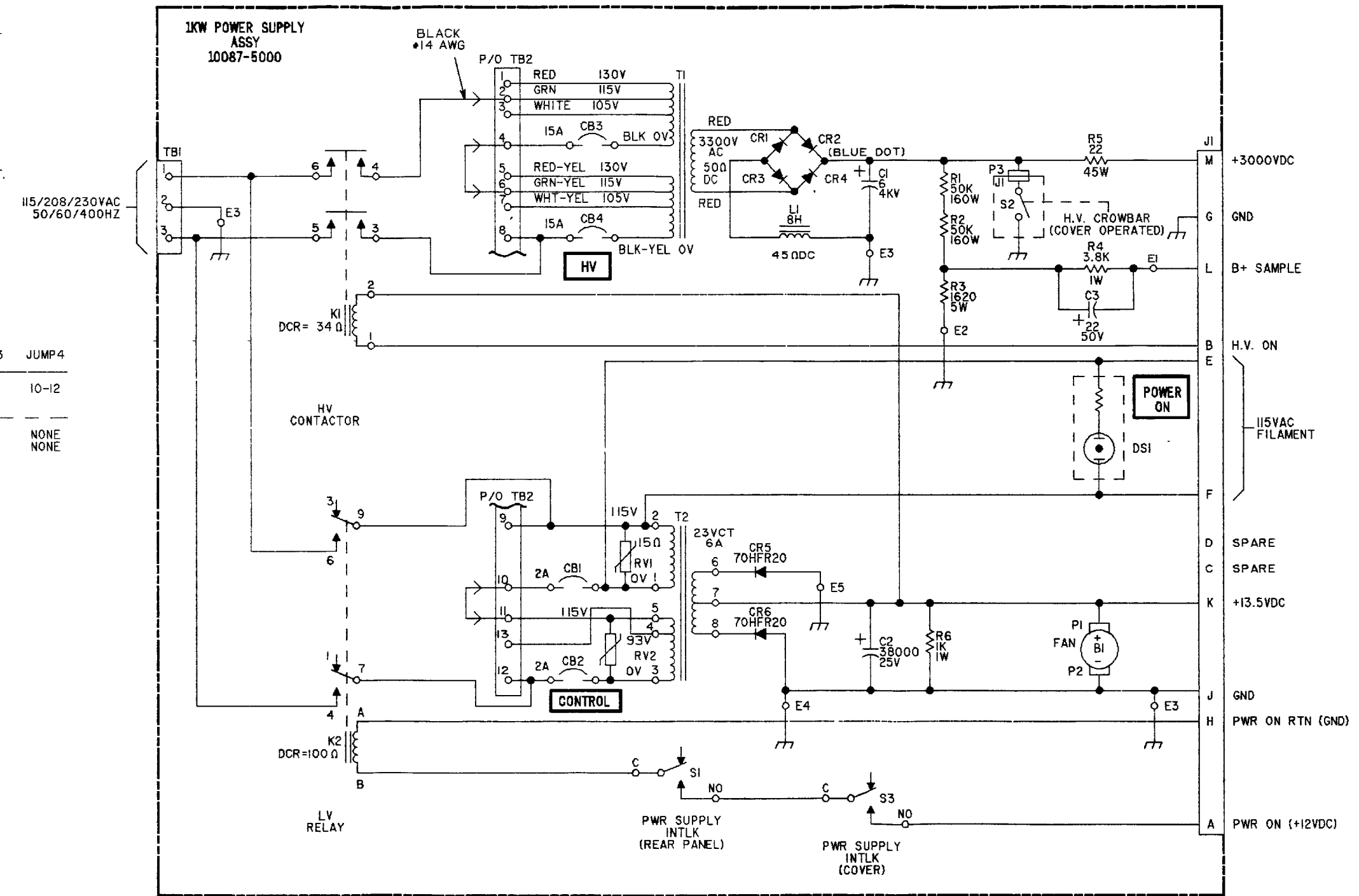

Figure FO-1. 1 KW Power Supply Schematic Diagram  
FP-1/(FP-2 Blank)

